

CODE ANALYSIS  
 OCCUPANCY TYPE: A3  
 TOTAL TENANT SPACE SQUARE FOOTAGE- 28, 289 S.F.  
 PARTY ROOMS- 1,915 S.F.  
 1,915 S.F. / 150 S.F. PER PERSON- 128 OCCUPANTS  
 LOUNGE- 990 S.F.  
 990 S.F. / 15 S.F. PER PERSON- 66 OCCUPANTS  
 MAIN COURT- 4049 S.F.  
 MAX ALLOWABLE OCCUPANCY PER TRAMPOLINE MANUFACTURER- 25  
 KID'S COURT- 750 S.F.  
 MAX ALLOWABLE OCCUPANCY PER TRAMPOLINE MANUFACTURER- 6  
 BASKETBALL COURT- 450 S.F.  
 MAX ALLOWABLE OCCUPANCY PER TRAMPOLINE MANUFACTURER- 3  
 DODGEBALL COURT #1- 2,569 S.F.  
 MAX ALLOWABLE OCCUPANCY PER TRAMPOLINE MANUFACTURER- 12  
 DODGEBALL COURT #2- 2,569 S.F.  
 MAX ALLOWABLE OCCUPANCY PER TRAMPOLINE MANUFACTURER- 12  
 DODGEBALL COURT #3- 2,116 S.F.  
 MAX ALLOWABLE OCCUPANCY PER TRAMPOLINE MANUFACTURER- 3  
 REMAINING S.F.- 12,851 S.F.  
 SPORT FACILITY WITH NO SPECTATOR SEATING- 508 S.F. GROSS PER OCCUPANT  
 12,851 S.F. / 50 S.F. PER OCCUPANT - 257 OCCUPANTS  
 TOTAL OCCUPANCY- 517 OCCUPANTS

PLUMBING FIXTURES REQ'D:  
 485/2 - 227.5  
 MEN: 227.5/125 = 2 WATER CLOSETS REQ'D (4 SHOWN EXISTING)  
 WOMEN: 227.5/65 = 4 WATER CLOSETS REQ'D (4 SHOWN EXISTING)

NUMBER OF EXIT DOORS REQ'D BASED ON OCCUPANT COUNT- 3  
 NUMBER OF EXIT DOORS SHOWN- 3

EGRESS REQ:  
 458 OCCUPANTS x 0.2" = 91" WIDTH  
 EGRESS WIDTH SHOWN PROVIDED- 100"

FUTURE TENANT STORAGE AREA- 4,066 S.F.  
 4,066 S.F. / 500 S.F. PER OCCUPANT = 8 OCCUPANTS.

1 LIFE SAFETY PLAN  
 Scale: 1/16" = 1'-0"

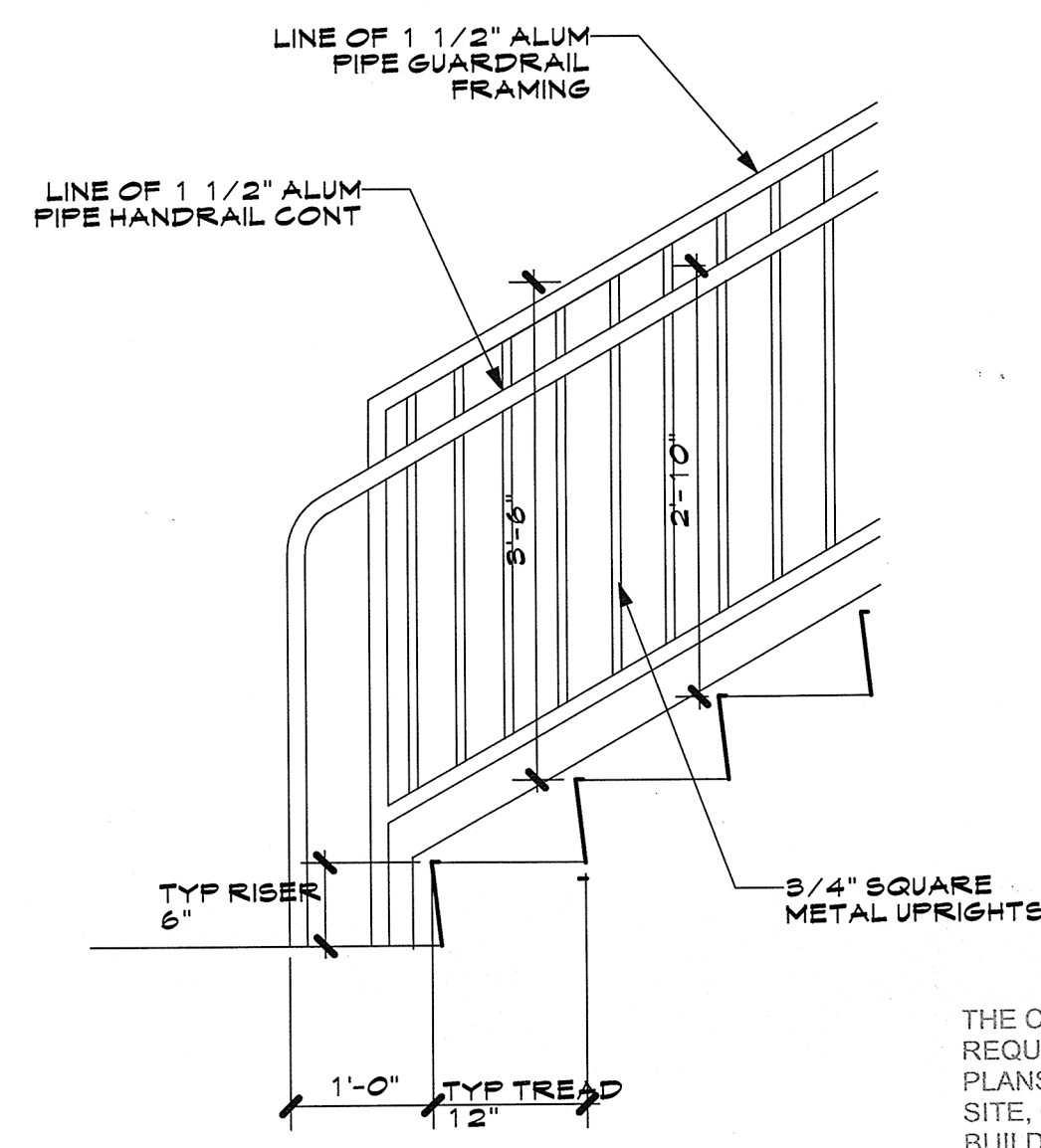

2 STAIR SECTION  
 Scale: 3/4" = 1'-0"

THE CITY OF TULSA BUILDING CODE  
 REQUIRES THAT THIS SET OF APPROVED  
 PLANS SHALL BE KEPT AT THE BUILDING  
 SITE, OPEN TO INSPECTION OF THE  
 BUILDING OFFICIAL OR HIS AUTHORIZED  
 REPRESENTATIVE AT ALL REASONABLE TIMES

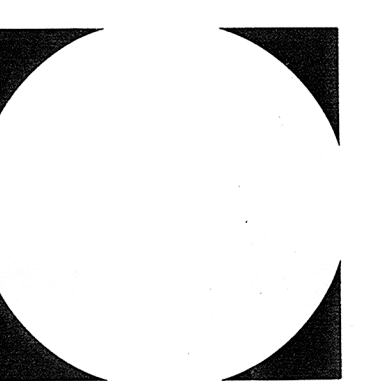

THE AIRPORT  
 EXISTING FACILITY REMODEL  
 TULSA, OK  
 5315 E 41st St



FOR BUILDING PERMIT PURPOSE ONLY

Michael McCoy  
**architects** llc  
 405.769.9802  
 fax 405.259.9013  
 1020 s. westminster  
 midwest city, ok 73130

issue date  
 2/28/14  
 revisions  
 5/20/14  
 sheet  
**LS 1**  
 of ONE



FOR BUILDING PERMIT PURPOSE ONLY

**Michael M Architects** Inc  
 405.769.9802  
 405.259.9013

**Michael M Architects**  
 1020 S. Westminister  
 Midwest City, OK 73130

Issue date: 2/28/14  
 Revisions: 5/15/14  
 Sheet: A1 of ONE

THE CITY OF TULSA BUILDING CODE  
 REQUIRES THAT THIS SET OF APPROVED PLANS SHALL BE KEPT AT THE BUILDING SITE, OPEN TO INSPECTION OF THE BUILDING OFFICIAL OR HIS AUTHORIZED REPRESENTATIVE AT ALL REASONABLE TIMES

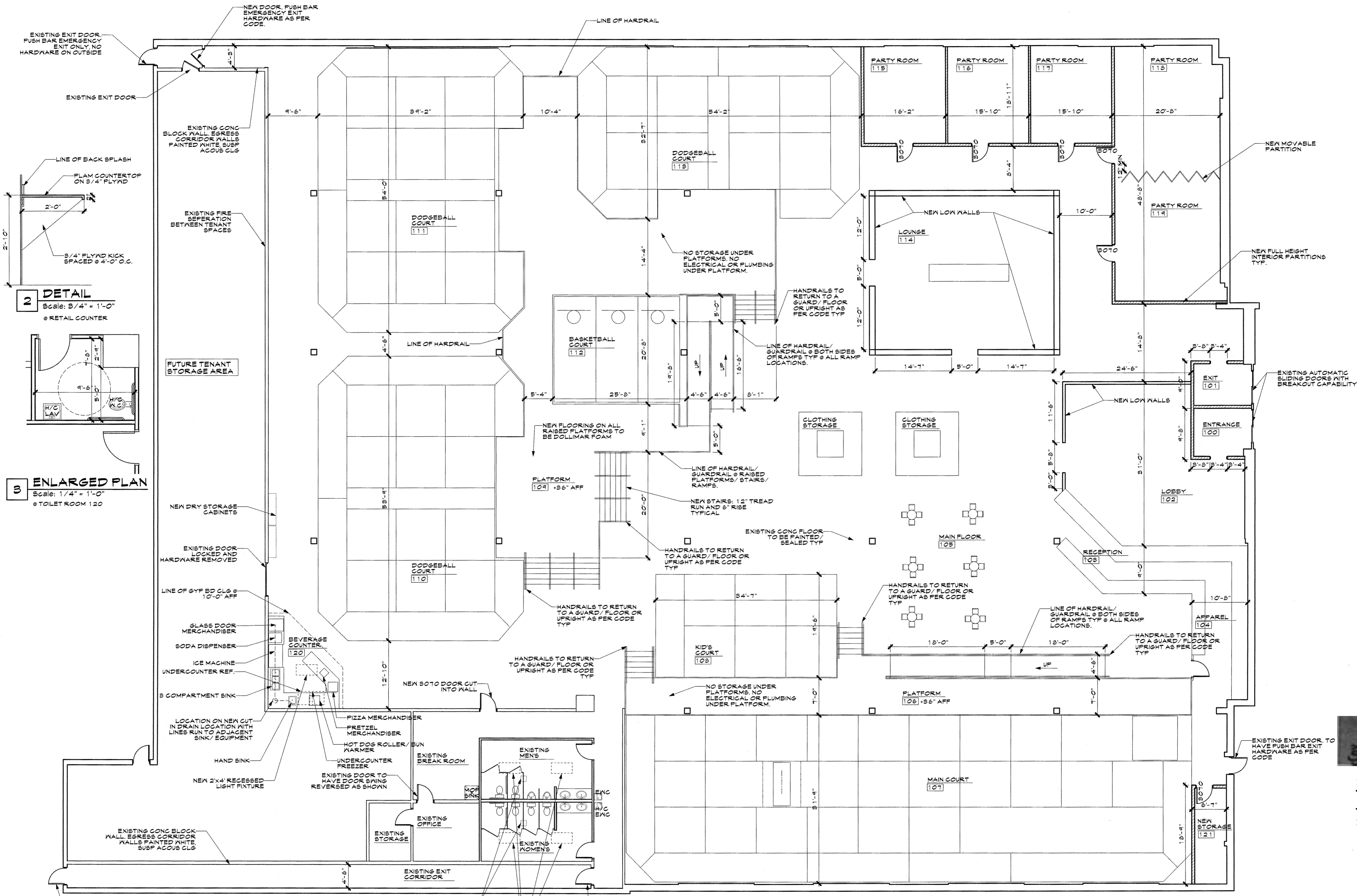

EXISTING EXIT DOOR TO HAVE PUSH BAR EXIT HARDWARE AS PER CODE

EXISTING EXIT DOOR, PUSH BAR EMERGENCY EXIT HARDWARE AS PER CODE

NEW MOVABLE PARTITION

NEW FULL HEIGHT INTERIOR PARTITIONS TYP.

EXISTING AUTOMATIC SLIDING DOORS WITH BREAKOUT CAPABILITY

NEW STORAGE 121

APPAREL 104

LOBBY 102

ENTRANCE 100

EXIT 101

RECEPTION 103

MAIN FLOOR 105

MAIN COURT 107

PLATFORM 106 +36" AFF

PLATFORM 108 +36" AFF

CLOTHING STORAGE

CLOTHING STORAGE

CLOTHING STORAGE

NO STORAGE UNDER PLATFORMS. NO ELECTRICAL OR PLUMBING UNDER PLATFORM.

HANDRAILS TO RETURN TO A GUARD/FLOOR OR UPRIGHT AS PER CODE TYP

LINE OF HARDRAIL/GUARDRAIL @ BOTH SIDES OF RAMPS TYP @ ALL RAMP LOCATIONS.

NO STORAGE UNDER PLATFORMS. NO ELECTRICAL OR PLUMBING UNDER PLATFORM.

DODGEBALL COURT 113

DODGEBALL COURT 111

DODGEBALL COURT 110

BASKETBALL COURT 112

LOUNGE 114

PARTY ROOM 115

PARTY ROOM 116

PARTY ROOM 117

PARTY ROOM 118

PARTY ROOM 119

NEW LOW WALLS

NEW LOW WALLS

NEW LOW WALLS

NEW LOW WALLS

NEW LOW WALLS

NEW LOW WALLS

NEW LOW WALLS

NEW LOW WALLS

NEW LOW WALLS

NEW LOW WALLS

NEW LOW WALLS

NEW LOW WALLS

NEW LOW WALLS

NEW LOW WALLS

NEW LOW WALLS

NEW LOW WALLS

NEW LOW WALLS

NEW LOW WALLS

NEW LOW WALLS

NEW LOW WALLS

NEW LOW WALLS

NEW LOW WALLS

NEW LOW WALLS

NEW LOW WALLS

NEW LOW WALLS

NEW LOW WALLS

NEW LOW WALLS